

AL6000 / AL6000HD UNIVERSAL HYBRID LIFT

OWNER'S MANUAL

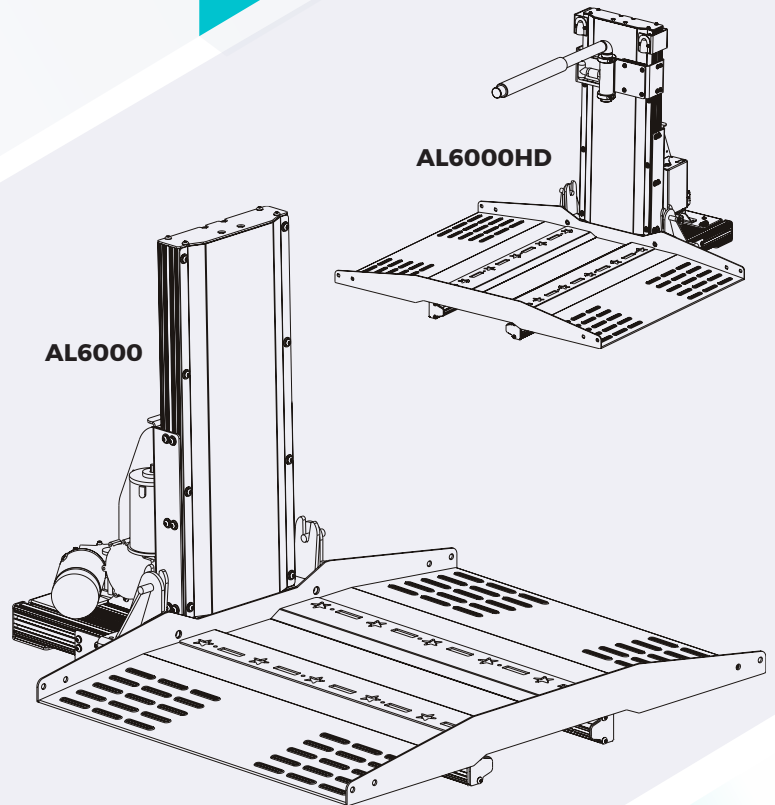

THANK YOU

From all of us at Harmar, thank you for placing your trust in our products and allowing us to be a part of your journey.

For more than 20 years we have been committed to building products that help you maintain independence. With a drive to empower people to live as they choose, Harmar Lifts Lives.

Beyond vehicle lifts, like the one you've purchased, Harmar designs and manufactures Vertical Platform Lifts, award-winning Stair Lifts, and more.

We strive to be the leading provider of lift-assisting technology in your home and on the road.

Visit harmar.com or speak to your dealer about the other solutions available from Harmar.

TABLE OF CONTENTS

SAFETY	4
Safety Definitions	4
INTRODUCTION	6
Device Name:	
AL6000 / AL6000HD Hybrid Vehicle Lifts	6
Read and Understand	6
Technical Specifications	6
OPERATION	7
Loading and Securing a Mobility Device	7
Securement with Cambuckle Retention Straps ...	8
Securement with optional Q'Straint Retractors..	10
Securement with optional Hold-down Arm	10
Puddle Lights (optional)	11
Unloading a Mobility Device	11
SAFETY & MAINTENANCE	13
Owner/Maintenance	13
Maintenance/Service Record	14
WARRANTY	16

SAFETY

SECTION 1

SAFETY

SAFETY DEFINITIONS



This safety alert symbol appears with safety statements. It means attention, become alert, your safety and the safety of others are involved! Please read and abide by the message that follows the safety alert symbol.

WARNING

Indicates a hazardous situation that, if not avoided, could result in death or serious injury.

CAUTION

Indicates a hazardous situation that, if not avoided, could result in minor or moderate injury.

NOTICE

Indicates a situation which can cause damage to the lift and/or the environment, or cause the lift to operate improperly.

NOTE: Indicates a condition that should be followed in order for the lift to function in the manner intended.

If you do not understand any portion of the installation or operation procedures, please consult Harmar's Technical Service Department at 800-833-0478. Do not attempt to install or use this lift if you have any hesitation or question. Serious injury or damage can result if proper procedures are not followed.

Consider the following general information when using your lift. Specifics may vary based on your chair model and lift combination.

Always make certain your lift is fully deployed and flush with the ground prior to loading your mobility device.

Ensure you have positioned the chair properly on the platform and that it is secured on the lift before transport. In some applications, accessories may have to be removed from the mobility device. The seat back angle may have to be opened forward or folded down flat.

Always verify wheels are captured by cradles or aligned evenly on the platform. Also ensure the securement device is fully engaged (hold-down device or retention straps). Please consult your dealer on the specifics of your application if you have questions.

Always drive slowly over rough terrain such as potholes, unpaved roads, railroad tracks, speed bumps or other uneven surfaces. Excessive loads and rough driving will damage your lift and will not be covered by the warranty.

Stop using the lift immediately if you notice any damage. Do not attempt to transport a mobility device with a compromised lift. Damage to your chair, lift and/or vehicle may occur. Contact your dealer and ask for an evaluation of the lift prior to further use.

Always check to make sure nobody is in the process of getting on or off the mobility device before operating the lift.

Always verify the mobility device is held firmly in place prior to transport.

Never attempt to move the vehicle without the lift being in the full stowed position and the cargo door/hatch closed.

⚠ WARNING

This lift is **NOT** meant for human transport. The chair or scooter **MUST** be unoccupied before operating the lift. Each lift is designed to transport a specific mobility device only. **DO NOT** attempt to move any mobility devices, objects, people, or materials other than those for which the lift was intended.

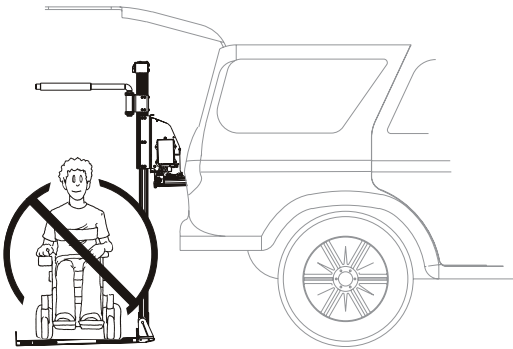
**⚠ CAUTION**

Do not allow anyone to use this lift unless they are properly instructed on operational and safety procedures.

⚠ WARNING

When using the lift, keep your hands and feet from under the platform.

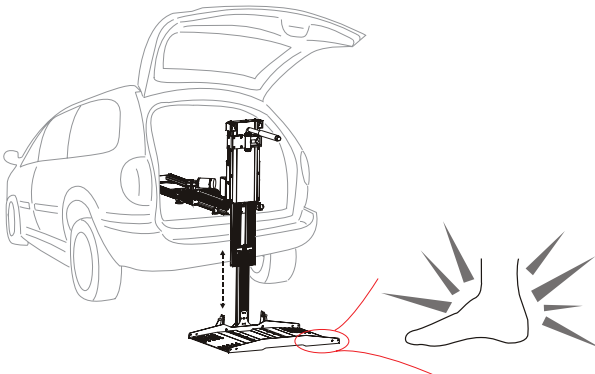
**⚠ WARNING**

Beware of Pinch Points. These are areas of moving parts that can catch extremities or clothing. Do not place fingers, extremities, clothing or jewelry near pinch points.

INTRODUCTION

SECTION 2

INTRODUCTION

DEVICE NAME: AL6000 / AL6000HD HYBRID VEHICLE LIFT

Indications of Use: The intended use of the AL6000 / AL6000HD is to lift, secure and transport an unoccupied mobility device for patients or mobility-impaired persons.

READ AND UNDERSTAND

This manual provides instructions for proper use and maintenance of your AL6000 / AL6000HD Hybrid Vehicle Lift. Any alterations to the equipment without written authorization by the manufacturer is prohibited and will void the warranty.

If you have questions concerning the operation and maintenance of your Hybrid Vehicle Lift, please contact your dealer.

Please ensure that you fill out the separate warranty form and return it within ten (10) days of installation to register your lift.

TECHNICAL SPECIFICATIONS

Visit harmar.com for specifications on the specific lift model and configuration.

SECTION 3

OPERATION

LOADING AND SECURING A MOBILITY DEVICE

Using the wired hand control or optional wireless key-fob controller, lower the lift platform until it reaches the ground and becomes level. Start by activating the hand control with the power button. The hand control has two operating buttons, UP to raise and stow the platform and DOWN to draw out and lower the platform, that must be depressed and held to complete the desired function. The hand control has integrated LED lights that can be used as a flashlight at night. The hand control can be aimed at the ground or at the vehicle to assist in ensuring the path is unobstructed. *See Figure 3-1.*

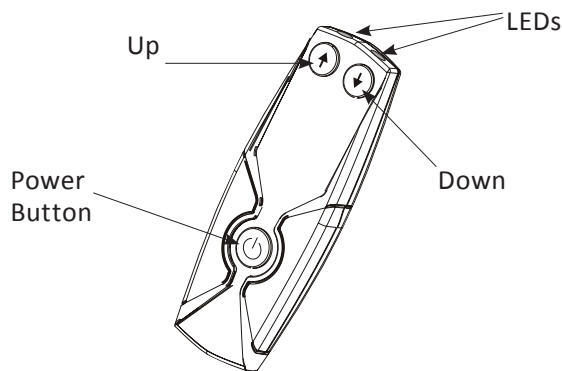

Figure 3-1

NOTICE

The power button must be pressed to enable the hand control to operate. At which time, the buttons will light up and the front LED's will act as a flashlight.

If no button is pressed after approximately two minutes, the hand control will turn off automatically.

Press the power button to turn back on.

NOTE: The lift is designed to draw power from the car battery as needed and will operate while the vehicle is off. However, it is recommended that the lift be operated while the car is running for optimal performance.

1. Loading the mobility device onto the platform. Determine the heaviest portion of the mobility device. This is usually under the drive wheels, motor(s), and batteries. Always walk the mobility device onto the platform with the heaviest portion closest to the lifting tower. If loading a scooter and the platform has the AL617 extension plate, position the scooter so the front wheels are resting on the extension plate, and the rear wheels are on the main platform. This allows the heaviest portion of the scooter to be closest to the lifting tower. Set your mobility device speed control to slow speed to maneuver easily onto the platform. *See Figures 3-2.*

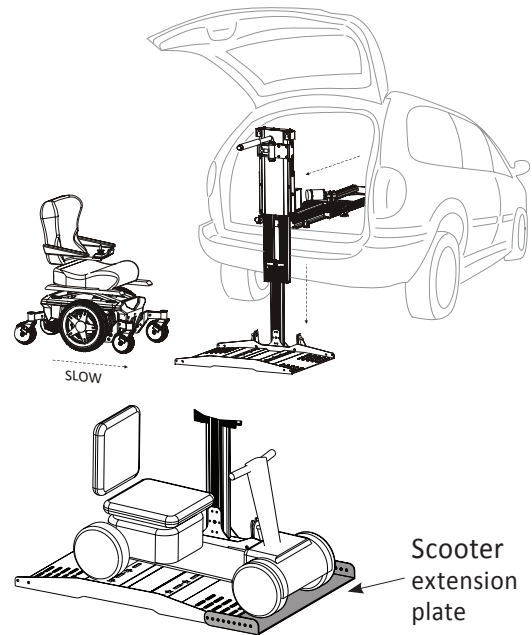

Figure 3-2

OPERATION**⚠ CAUTION**

Do not ride on the mobility device when loading and unloading the platform.

Note: Please ensure hand control wire does not interfere with the movement of the lift. Improper operation can result in damage not covered by manufacturers warranty.

⚠ CAUTION

Ensure no part of the mobility device extends beyond the space of the platform. Pay particular attention to areas above the platform as cargo openings are often more compact towards the top.

SECUREMENT WITH CAMBUCKLE RETENTION STRAPS

1. Each corner of the AL6000 platform has a restraint attached with a hook on the end. Place each hook in either the anchor plate slot, each U-bolt, or tie-down loops attached to the mobility device. **See Figure 3-3.**

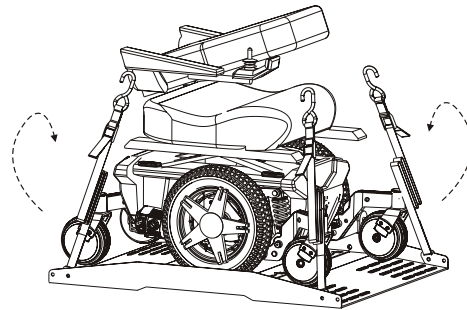

Figure 3-3

2. Pull the loose end of each strap tight. To release, simply press the release tab on the cambuckle, pull and remove the hooks. **See Figure 3-4.**

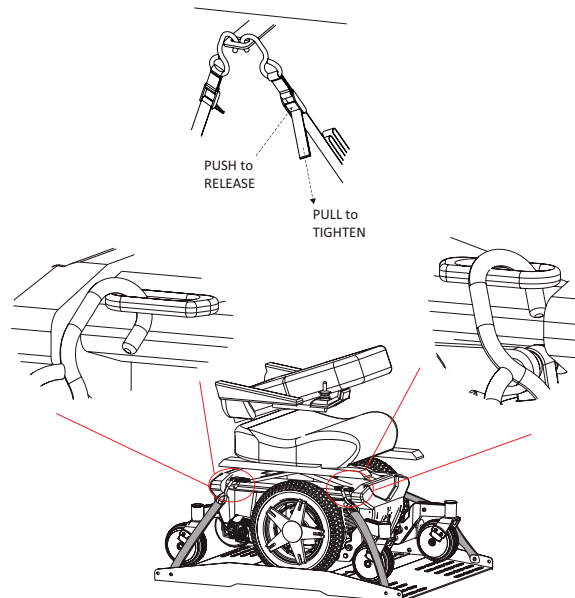

Figure 3-4

NOTE: Elevate the platform with the mobility device 18" or so off the ground to secure the straps. It's much easier to complete the work at waist height.

3. If the chair has a folding seatback, it may be placed in the down position for easier clearance when loading the chair into the vehicle. Depending on the size of the chair, the headrest may have to be removed as well.
4. Use the wired hand control or optional wireless key-fob controller, to raise and retract the platform into the stowed/travel position. **See Figure 3-6.**

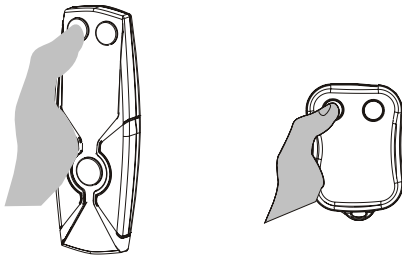

Figure 3-6

5. Double-check that the mobility device is secured properly on the platform. While holding the hand control, stand to the side and away from the lift. Press the "Up" button. When the platform stops retracting, release the button. The platform will automatically lock itself into a travel position. Close the door slowly, making sure that no part of the mobility device or other objects in the cargo area contacts the door. **See Figure 3-5.**

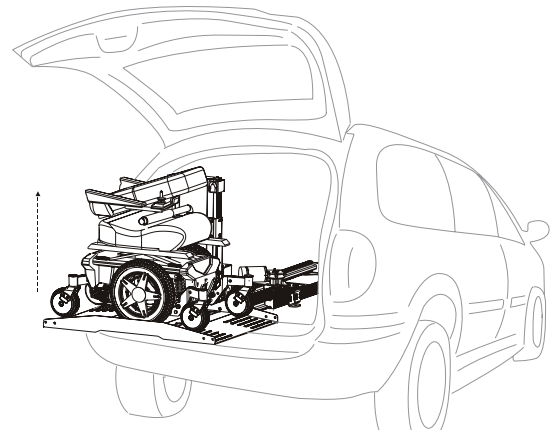

Figure 3-5



CAUTION

Be sure to look closely at both sides and the top while retracting into the vehicle to ensure no part of the mobility device will get caught on the edges of the vehicle opening.

6. The wired hand control comes equipped with a magnetic back. Once the platform is completely stowed in the vehicle, simply attach the wired hand control to a metal surface for easy retrieval.

OPERATION

SECUREMENT WITH OPTIONAL Q'STRAIT RETRACTORS

1. With the optional Q'Strait retractors, place each hook in the appropriate anchor plate slot, U-bolt, or tie-down loop. The straps will automatically retract and secure the mobility device. Make sure each strap retracts without any interference or slack in the strap. Adjust if necessary. To release, press and hold the lever to release the straps and then remove the hooks. *See Figure 3-7.*

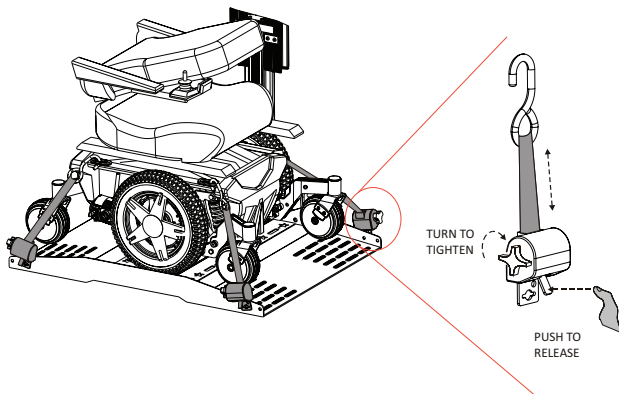

Figure 3-7

2. Either two or four retractor configurations can be used. For two retractor systems, one Q'Strait should be located on each corner opposite each other on the platform. *See Figure 3-8.*

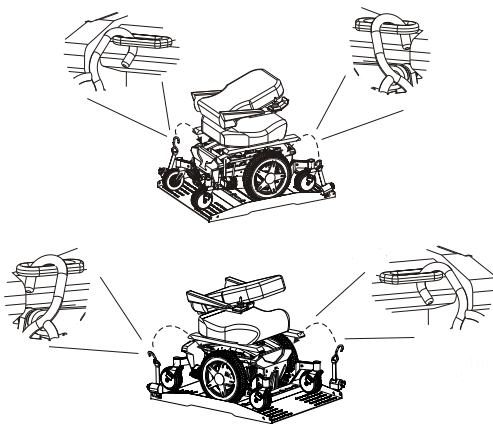

Figure 3-8

SECUREMENT WITH OPTIONAL HOLD-DOWN ARM

1. The hold-down arm may be rotated out of the way. Pull the T-handle and rotate the hold-down arm to the desired position. Release the T-handle to lock in place. *See Figure 3-9.*

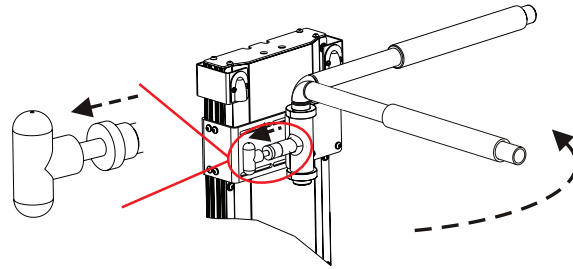

Figure 3-9

2. The hold-down arm can be rotated over the center of the seat. Pull the T-handle and rotate the arm to the desired position. Release the T-handle to lock in place. *See Figure 3-10.*

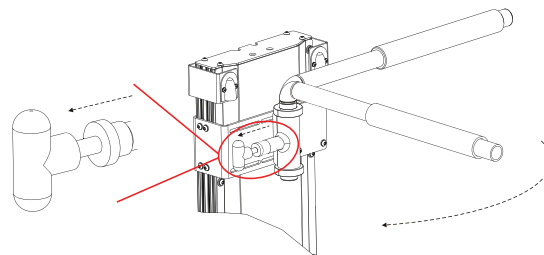

Figure 3-10

NOTICE

The armrest of the mobility device may have to be raised or removed to properly position the hold-down arm to avoid damage.

PUDDLE LIGHTS (OPTIONAL)

LEDs will illuminate automatically when the platform reaches its out position. The LEDs will stay on as long as the platform is out of the vehicle, UP or DOWN. Once the platform starts to travel horizontally (inward), the LEDs will turn off.

See Figure 3-11.

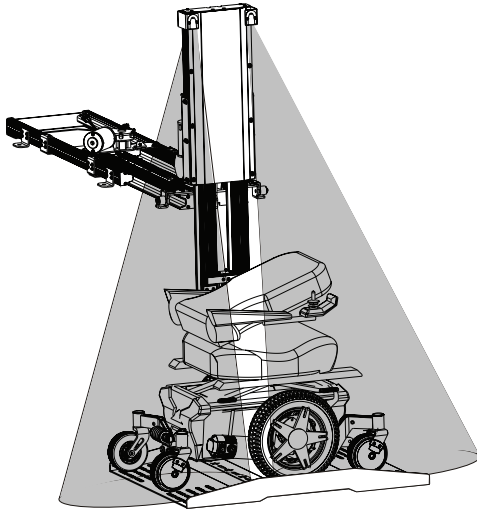

Figure 3-11

If the lift is left out / down for an extended period of time, the power switch on top of the control box has to be switched to the OFF position to turn off the LEDs. *See Figure 3-12.*

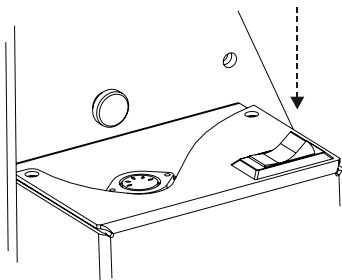

Figure 3-12

UNLOADING A MOBILITY DEVICE

1. Open the rear cargo door. Double-check that the mobility device did not shift during travel and is properly secured onto the platform. Stand to the side of the vehicle and press the “Down” button until the lift reaches the ground.

See Figure 3-13.

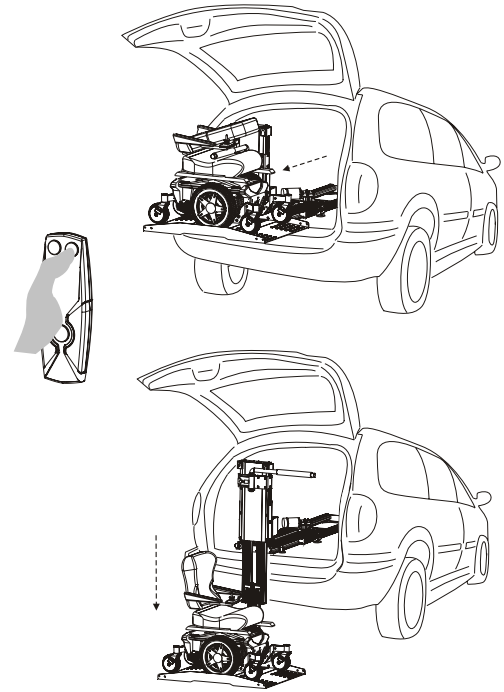

Figure 3-13

2. If the lift is secured with the cambuckle securement straps, loosen the straps by pressing the release tab on the cambuckle, pull, and then remove the hooks. *See Figure 3-14.*

OPERATION

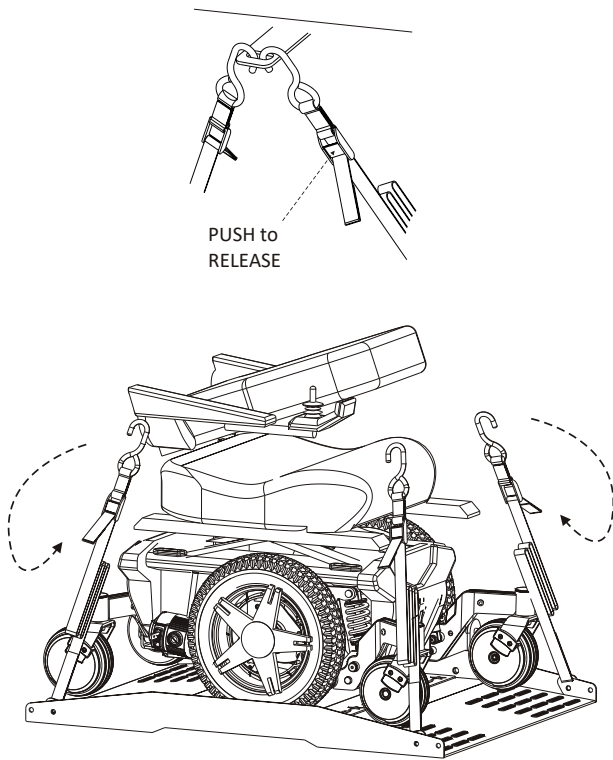

Figure 3-14

3. If the lift has the optional Q'Straint retractors, press and hold the red lever to release the straps and unhook them from the anchor plates, U-bolt, or tie-down loops. *See Figure 3-15.*

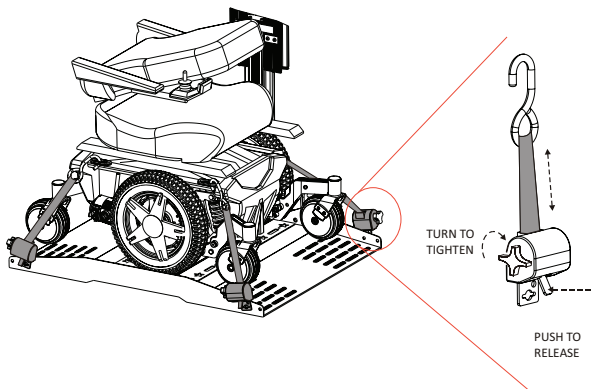

Figure 3-15

4. If the lift is equipped with the optional hold-down arm, the hold-down arm may need to be rotated out of the way. Pull the T-handle and rotate the hold-down arm. Release the T-handle to lock in place. *See Figure 3-16.*

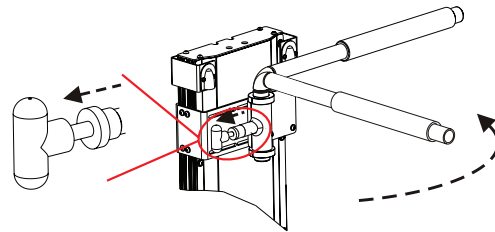

Figure 3-16

5. Slowly walk the mobility device off of the platform, backing out the same way the platform was entered. *See Figure 3-17.*

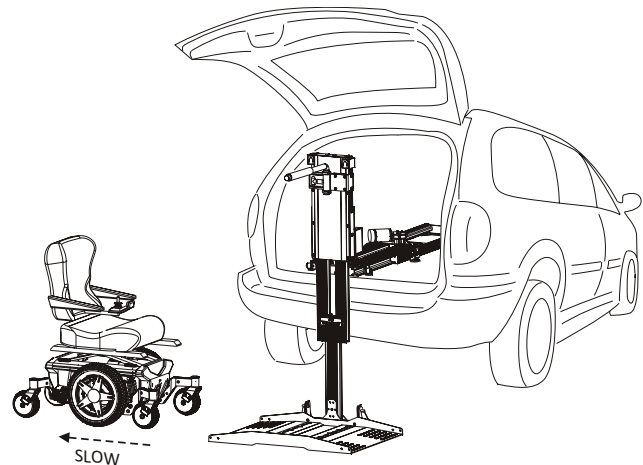

Figure 3-17

6. Press and hold the UP button to stow the unloaded platform back into the vehicle.

SECTION 4

SAFETY & MAINTENANCE

Except as described elsewhere in this manual, maintenance must be performed only by qualified technicians. Contact a local dealer with questions or to schedule any needed inspections, repairs, or service.

This hybrid lift is designed to be as trouble-free as possible, but as with any mechanical device, regular maintenance will help ensure that it continues to offer reliable and safe use for years to come.

We recommend that a preventative safety and maintenance inspection is scheduled with a local dealer at least once a year on motors, lift frame, wiring harness, strap integrity, and all moving parts of the lift.

- Check for paint chips and touch up bare metal. Use a good black enamel or lacquer to inhibit rust. This may need to be done more frequently if the lift is subject to salt air or road salt.

OWNER/MAINTENANCE

Before Use: Do not use lift until these conditions are rectified.

- Check for any obstructions in the path of the lift. Keep items away from aluminum channels. Hand control must not obstruct the travel area of the lift.
- Visually check lifting strap (during empty travel) before loading chair.
- Clean any debris from the platform.
- Keep hand control cord away from moving parts.
- Avoid loose items in the cargo area of the lift.
- If applicable, change wireless key-fob controller batteries annually.
- If any unusual noise or noticeable change occurs in the speed or travel of the lift, please contact your service technician.

[illegible]

MAINTENANCE

[illegible]

WARRANTY

SECTION 7

3-YEAR LIMITED WARRANTY**PRODUCTS COVERED: AL6000 SERIES MODELS**

The lift came with a separate warranty form on page 17. To register the lift, the warranty form must be returned within ten (10) days of installation. This warranty policy page must remain in the owner's manual for future reference. Do not tear out this page.

Dealer/Installer Name: _____

Address: _____

Phone: _____

E-Mail: _____

The installation date and serial # of the lift will be required for the dealer to receive factory information for service or warranty work.

Installation Date: _____

Serial # of the Lift: _____

THIS EXPRESS WARRANTY IS IN LIEU OF ALL OTHER WARRANTIES OR CONDITIONS, INCLUDING ALL IMPLIED WARRANTIES OR MERCHANTABILITY OR FITNESS FOR A PARTICULAR PURPOSE, AND THERE ARE NO WARRANTIES THAT EXTEND BEYOND THE DESCRIPTION OF THE LIMITED WARRANTY DESCRIBED HEREIN. THIS WARRANTY GIVES YOU SPECIFIC LEGAL RIGHTS AND YOU MAY ALSO HAVE OTHER LEGAL RIGHTS WHICH VARY FROM STATE TO STATE.

Harmar Mobility warrants to the original purchaser of the vehicle lift manufactured by Harmar to be free of defects in material, mechanical and electrical component (parts), excluding labor costs, paint and covers, for a period of three (3) years from date of retail purchase, provided that the products have been installed and maintained by an authorized Harmar distributor or certified Harmar installer and operated properly.

This warranty does not cover defects in vehicles on which Harmar products are installed or malfunctions in Harmar products caused by defects in any part of the vehicle upon which the product is installed. This warranty does not cover maintenance or adjustments. Harmar will not be charged for labor, consequential damage or repair expenses. Harmar will not, under any circumstances, be liable for the loss of the use of its products or loss of time. This warranty becomes null and void if the product has been lost, damaged by accident, over-stressed, misused and/or neglected, or if the product has been modified in any way. Defective parts must be returned, prepaid, to Harmar, for inspection prior to credit, repair or replacement, at Harmar's option. Harmar's sole obligation and the exclusive remedy under this warranty is limited to such credit, repair or replacement. All warranty claims must be reported to the dealer from whom the lift was purchased as they have responsibility for handling warranty claims.

Dealers may charge for labor, service, travel, or other associated costs to make repairs, and such charges are not covered by this Limited Warranty.

All parts used to replace defective materials must be genuine Harmar parts to be covered by this Limited Warranty. This Limited Warranty grants specific legal rights, other rights vary from state to state.

PLEASE FILL OUT ALL FIELDS AND RETURN WITHIN TEN (10) DAYS OF PRODUCT INSTALLATION.

Fax completed form to 1-866-234-5680 or mail to:

Harmar, ATTN Warranty Department, 1500 Independence Blvd., Suite 220, Sarasota Florida 34234.

PRODUCT INFORMATION

Model: _____

Serial Number: _____

Purchase Date: _____

Installation Date: _____

PURCHASER INFORMATION

Name: _____

Address: _____

Phone: _____

Email: _____

INSTALLER INFORMATION

Company Name: _____

Contact Name: _____

Address: _____

Phone: _____

Fax: _____

Email: _____

ADDITIONAL INFORMATION

How did you hear about Harmar?

- ☐ Harmar Dealer
- ☐ Internet
- ☐ Magazine
Which: _____
- ☐ Friend or Acquaintance
- ☐ Saw Harmar product somewhere
- ☐ Other: _____

APPLICATION INFORMATION

☐ Scooter ☐ Power Wheelchair

☐ Wheelchair ☐ N/A

Year: _____

Manufacturer: _____

Model: _____

I purchased my Harmar lift because of:

- ☐ Style/Appearance
- ☐ Harmar Representative
- ☐ Previous Experience
- ☐ Ease of Use
- ☐ Recommendation
- ☐ Price/Value



WARRANTY

Page Intentionally Left Blank

[illegible]



1500 Independence Blvd., Suite 220 | Sarasota, FL 34234
800.833.0478
harmar.com